



# Optical Fiber Connector

## FC Optical Fiber Connector

### Description

An optical fiber connector terminates the end of an optical fiber, and enables quicker connection and disconnection than splicing. The connectors mechanically couple and align the cores of fibers so light can pass. Better connectors lose very little light due to reflection or misalignment of the fibers.

### Feature

- Low insertion loss
- High return loss
- Ease of installation
- Low cost
- Reliability
- Low environmental sensitivity
- Ease of use

### Application

- Telecom network
- Ethernet network
- Optical communication equipment

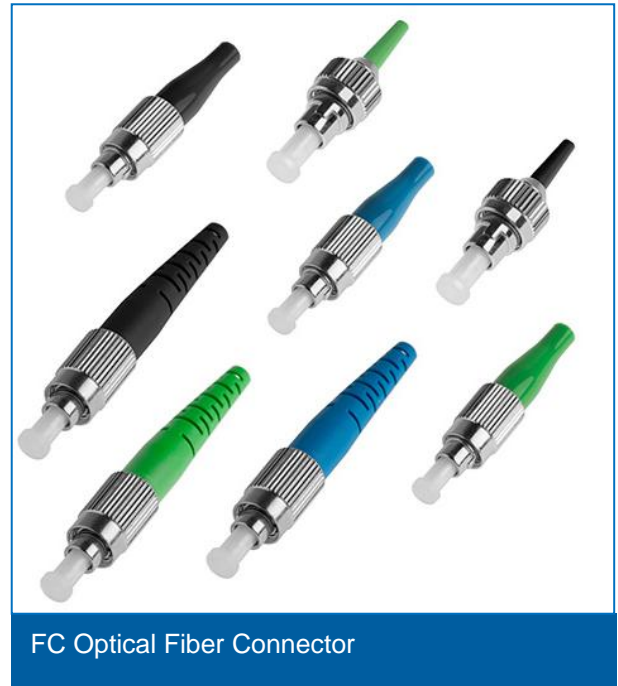

### Specification:

Items	Single mode	Multi mode
Insertion Loss	$\leq 0.3\text{dB}$	$\leq 0.3\text{dB}$
Return Loss	$\geq 50\text{dB(UPC)}; \geq 60\text{dB(APC)}$	$\geq 30\text{dB}$
Ceramic ferrule spec	125.5um concentricity deviations: $< 1\mu\text{m}$	127um concentricity deviations: $< 3\mu\text{m}$
Insert-pull test	1000 times $< 0.3\text{dB}$	
Operation temperature	$-40^{\circ}\text{C} \sim +85^{\circ}\text{C}$	
Suitable fiber	PC/APC(9/125um)	PC(50/125um,62.5/125um)

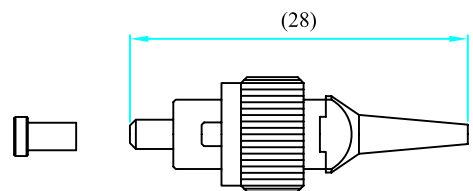
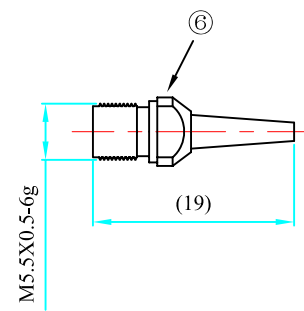
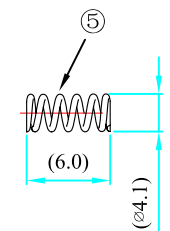
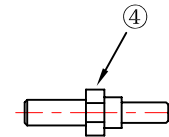
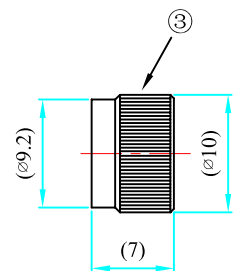
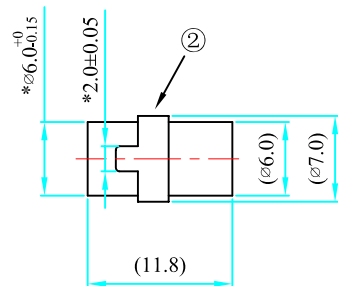
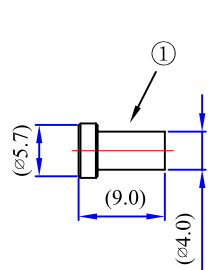

**Technical requirements:**

- 1.The dimensions on the drawing are just for reference, which important is to match well with each other;
- 2.The dimensions with "\*" are important,please control them strictly.

No.	Materia name	Q'ty	note
1	dust cap	1	PC dust cap is transparent, APC dust cap is green
2	front fixed part	1	
3	outer housing	1	
4	ferrule	1	ferrule:SM and MM, APC ferrule:cone and step
5	spring	1	
6	back fixed part	1	PC boot:black APC boot:green

Title			
0.9mm FC Connector			
Drawing	Steven	Item No	
Check	Henry	Drawing No:	
Approval	Williams		曦和光电科技有限公司 XH Opto Tech Co.,LTD
Date	2018	Page: 1-1	

A B C D E F G H

1

2

3

4

5

6

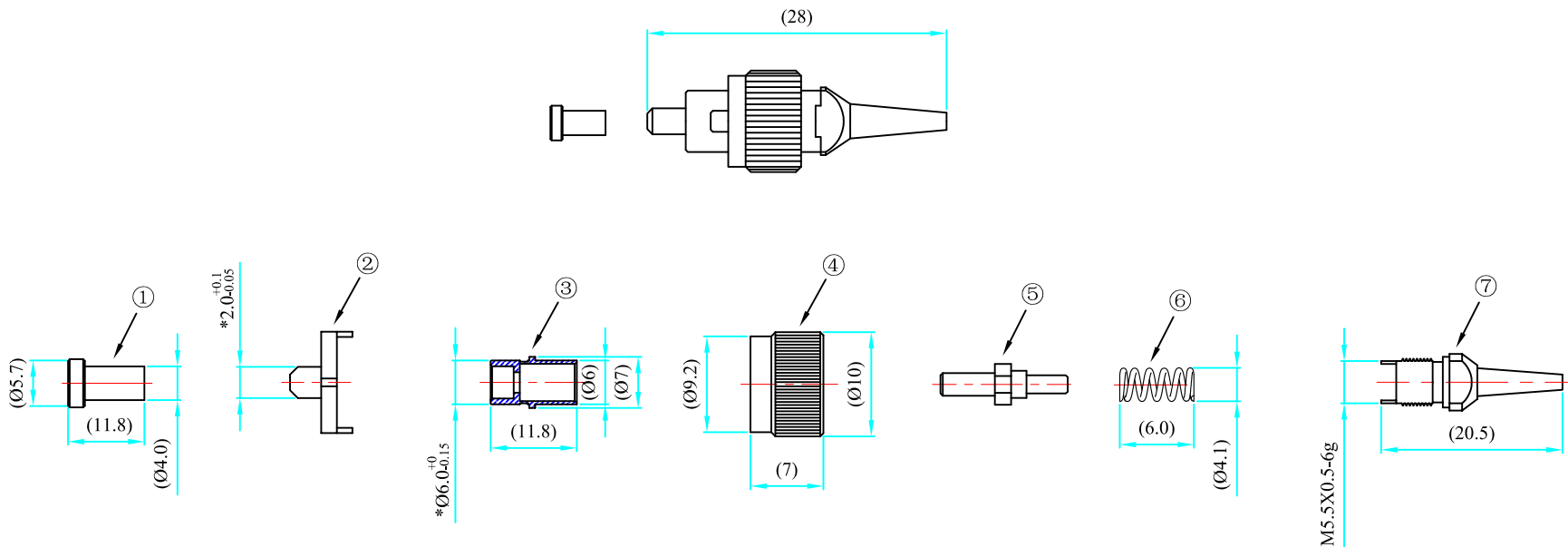

**Technical requirements:**

- 1.The dimensions on the drawing are just for reference, which important is to match well with each other;
- 2.The dimensions with "\*" are important,please control them strictly.

No.	Materia name	Q'ty	note
1	dust cap	1	PC dust cap is transparent. APC dust cap is green
2	holding ring	1	
3	front fixed part	1	
4	outer housing	1	
5	ferrule	1	ferrule:SM and MM. APC ferrule:zone and step
6	spring	1	
7	back fixed part	1	PC boot:black APC boot:green

Title		0.9mm FC Connector	
Drawing	Steven	Item No	
Check	Henry	Drawing No:	
Approval	Williams		曦和光电科技有限公司 XH Opto Tech Co.,LTd
Date	2018	Page: 1-1	

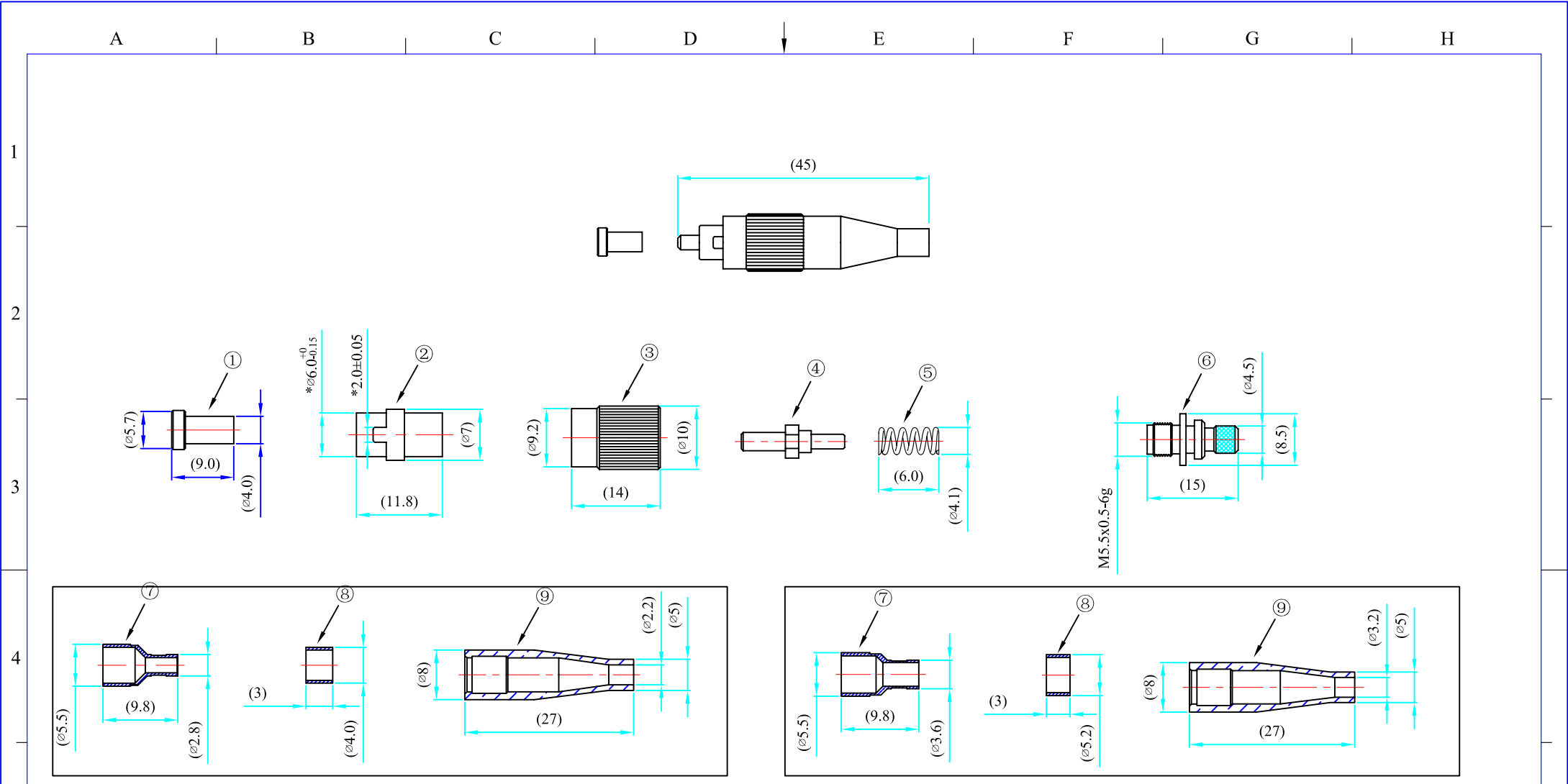

2.0 type

3.0 type

No.	Materia name	Q'ty	note
1	dust cap	1	PC dust cap is transparent. APC dust cap is green
2	front fixed part	1	
3	outer housing	1	
4	ferrule	1	ferrule:SM and MM. APC ferrule:cone and step
5	spring	1	
6	back fixed part	1	
7	crimping sleeve	1	
8	crimping ring	1	
9	boot	1	PC boot:black APC boot:green

Technical requirements:

- 1.The dimensions on the drawing are just for reference, which important is to match well with each other;
- 2.The dimensions with "\*" are important,please control them strictly.

Title			
<b>2.0/3.0mm FC Connector</b>			
Drawing	Steven	Item No	
Check	Henry	Drawing No:	
Approval	Williams		曦和光电科技有限公司 XH Opto Tech Co.,LTD
Date	2018	Page: 1-1	

A B C D E F G H

1

2

3

4

5

6

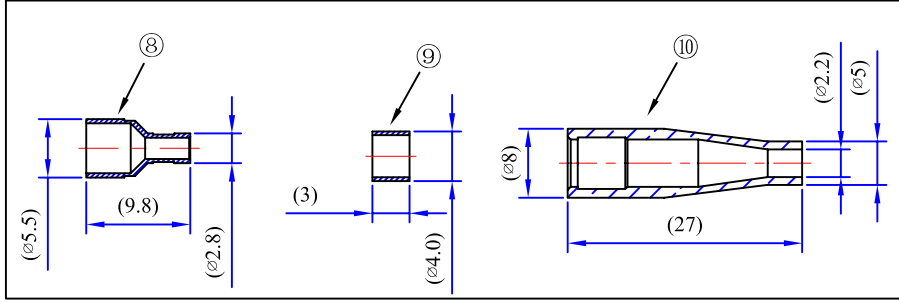
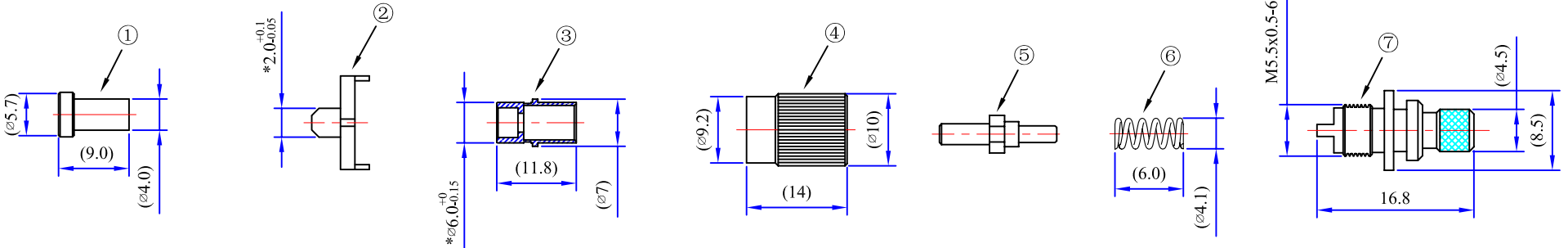
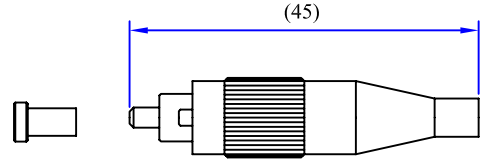

2.0 type

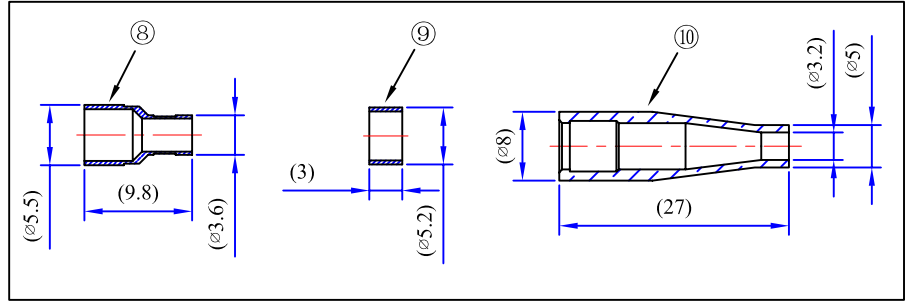

3.0 type

2.0/3.0 FC type adjusted Connector

No.	Materia name	Q'ty	note
1	dust cap	1	PC dust cap is transparent, APC dust cap is green
2	holding ring		
3	front fixed part	1	
4	outer housing	1	
5	ferrule	1	
6	spring	1	ferrule:SM and MM, APC ferrule:cone and step
7	back fixed part	1	
8	crimping sleeve	1	
9	crimping ring	1	
10	boot	1	PC boot:black APC boot:green

Technical requirements:

- 1.The dimensions on the drawing are just for reference, which important is to match well with each other;
- 2.The dimensions with "\*" are important,please control them strictly.

Title 2.0/3.0mm FC adjusted Connector			
Drawing	Steven	Item No	
Check	Henry	Drawing No:	
Approval	Williams		
Date	2018	Page: 1-1	職和光电科技有限公司 XH Opto Tech Co.,LTd